

# Professional Series Built in Double Oven



The Kleenmaid Professional range of built-in ovens combines stunning European styling with outstanding quality, enormous capacity and full multi-function capabilities to ensure exceptional cooking results every time.

The attention to detail and the focus on time saving innovations such as pyrolytic cleaning, programmable roast probes and fully electronic programmable timers ensure the Kleenmaid Professional range of built in ovens will enhance both your kitchen and your lifestyle, leaving you with more time to enjoy life.

#### Features:

Oven capacity:	83 litre capacity (both ovens)
Cooking programs:	8 multi-function programs (both ovens)
Special function:	Pyrolytic self cleaning function & programmable roast probe
Construction:	304 grade stainless steel
Timer:	Electronic fully programmable timer
Inclusions:	2 x oven wire racks
(Both ovens)	1 x telescopic rack
	1 x insert grill wire rack
	1 x baking pan
Electrical:	30 amp
Dimensions:	745mm (W) x 1220mm (H) x 564mm (D)

# 10

10 Year Warranty\*

For your nearest store call 13 13 08  
[www.kleenmaid.com.au](http://www.kleenmaid.com.au)

**Kleenmaid**  
 PROFESSIONAL

# Professional Series Built in Double Oven

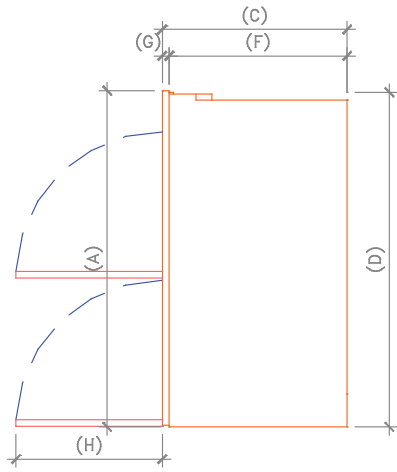

**OVEN SIDE ELEVATION**

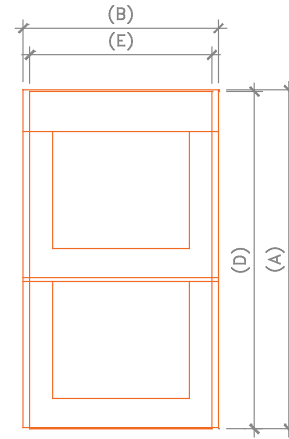

**OVEN FRONT ELEVATION**

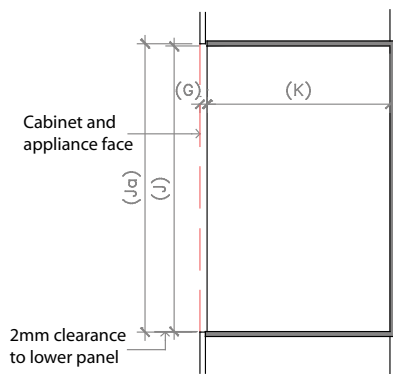

**CABINET SECTION**

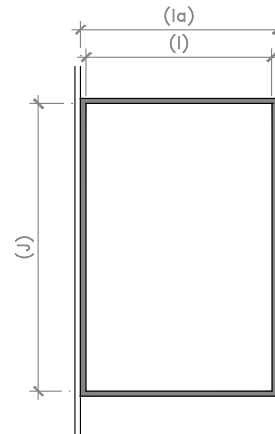

**CABINET FRONT ELEVATION**

REF	Appliance and cabinetry dimensions (mm)		TO951
Appliance	A	Overall height of appliance	1220
	B	Overall width of appliance (fascia)	745
	C	Overall depth of appliance (excluding handles/knobs)	567
	D*	Height of chassis	1210
	E	Width of chassis	710
	F	Depth of chassis	545
	G	Depth of oven frame and control panel (flush fitting cabinetry clearance)	22
	H	Depth of oven door when fully open (measured from front of control panel)	450
Cabinetry	I	Minimum inside width of cavity	715
	Ia	Overall width of cabinet module	750
	J*	Inside height of cavity	1215
	Ja	Minimum height for flush fit = A + clearances (2mm at bottom / balance at top)	1225
	K	Minimum inside depth of cavity	560
*	Height measurements are from cavity support base		

Model	Capacity (litres)	Electrical Ap-approval	Installation Method	Electrical Rating			
				Voltage	Hz	W	Amp
TO951X	83 each	Q03577	#Flush	240	50	7200	30

#Proud not recommended

# Professional Series Built in Double Oven

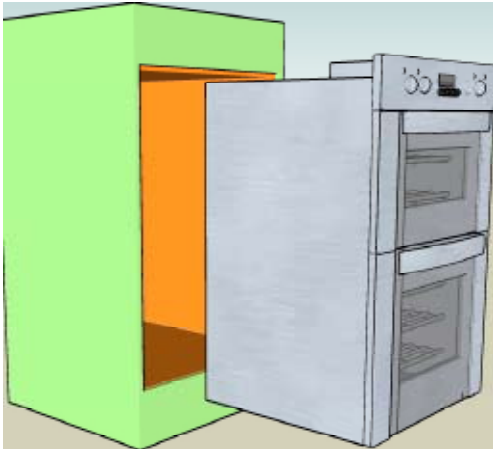

Cabinet & Oven Pictorial

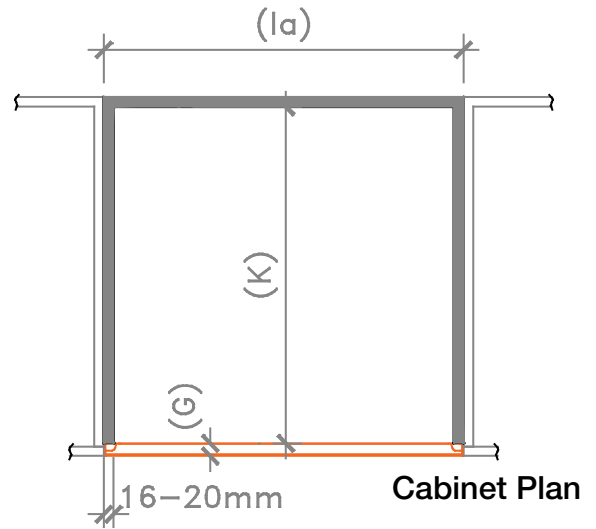

Cabinet Plan

## Flush Fitting Installation Options

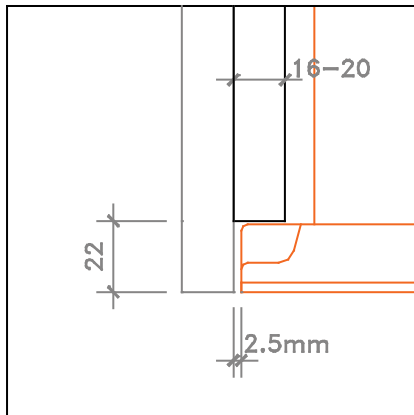

Adjacent Gable

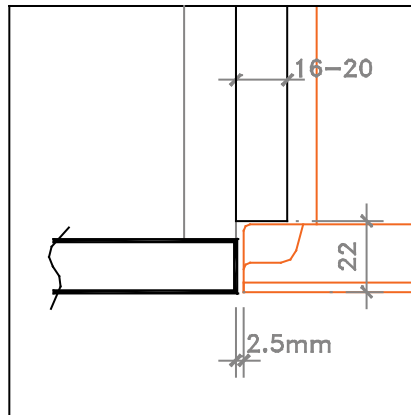

Adjacent Cupboard

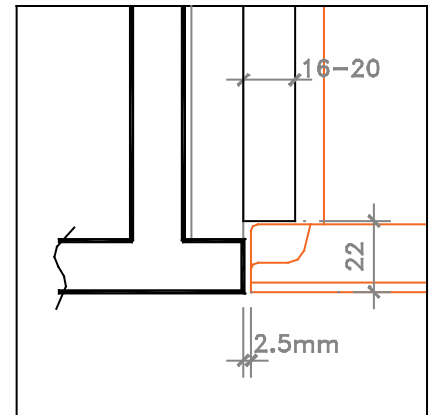

Adjacent Drawer

## Line Drawing

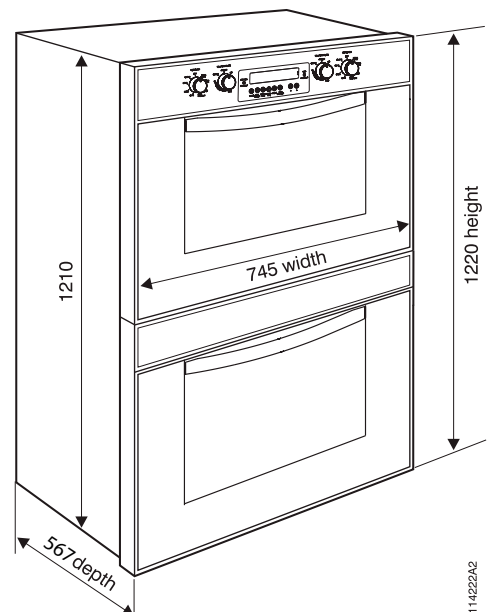

114222A2

### Installation Notes

1. Check measure appliance and ensure cabinet is constructed square and to dimensions required.
2. The oven is recommended for Wall Mounted installations.
3. Make sure that surrounding materials are heat resistant.
4. Oven support surface must be a minimum of 19mm thick plywood platform, solid, level and flush with the bottom of the cabinet cutout.
5. Oven is very heavy. Be very careful moving over surfaces & into cabinetry to avoid damage.
6. Align the oven centrally with respect to the side walls of the unit surrounding it and fix it in place carefully with the screws provided. Check oven is level & take care not to pinch wiring at oven rear.

# Installation Hints & Electrical Information

## Installation Hints & Electrical Information

### Instructions

Wall ovens should be mounted so that when the door is open fully, the top of the door is approximately waist level to allow the user easy access to the oven.

So that your oven maintains its efficient sealing capacity for the life of the appliance, NEVER USE THE DOOR AS A LEVER (especially when the oven is being installed into its recess). Similarly undue pressure must never be placed on the oven door when it is open.

### Electrical Connection

Connection to electrical mains must only be performed by a licenced electrical contractor. All care must be taken to ensure the installation is properly earthed and conforms to local codes. Ensure enough flex is provided when connecting electrical connections to allow for ease of installation and servicing of the appliance.

### Installation of wall ovens in vacuum formed vinyl/plastic materials

When wall ovens are installed in situations in conjunction with vacuum formed vinyl/plastic materials, formed onto a base material, it is essential to avoid direct radiation onto these surfaces and edges of doors and panels adjacent to the sides and top of the wall oven.

It is recommended that a heat barrier be fitted to avoid this radiated heat. (NOT SUPPLIED - Customer responsibility).

Following are two methods of protecting the doors or panels to the side of the oven, and one to protect the cabinets above the oven.

No responsibility can be accepted for any claims regarding the surrounding doors and panels if the installation is not to an approved manner.

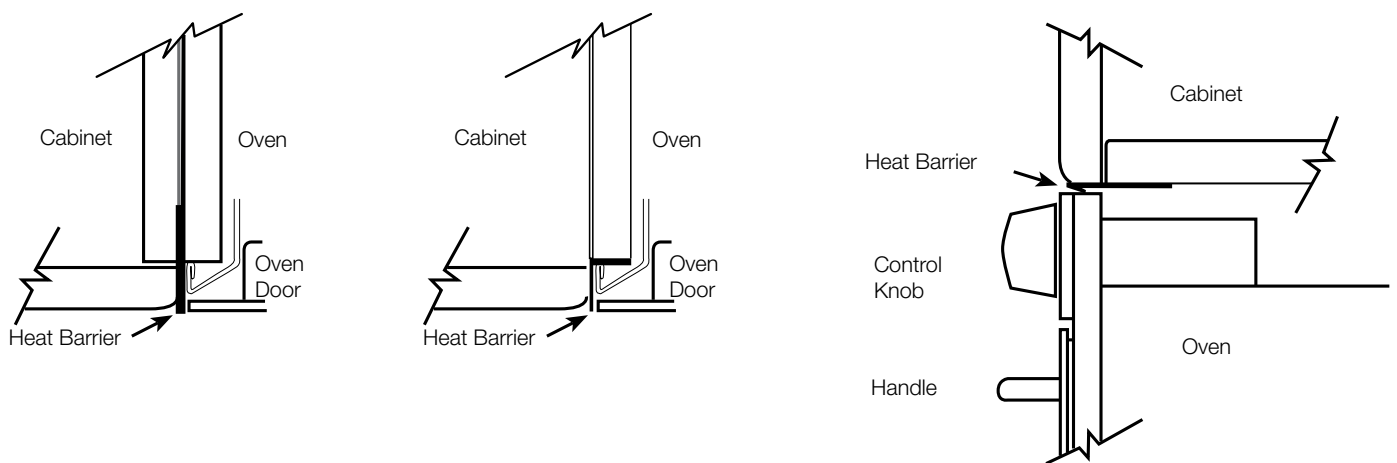

\* Technical Specifications and product sizes can be varied by Manufacturer without notice. Any cut-outs for appliances should only be by physical measurements. Drawings are not to scale. All information supplied is for general reference purposes only and is on the understanding that Kleenmaid Pty Ltd will not be liable for any loss, liability or damage whatsoever arising as a result of reliance of such information.